

RoHS Compliant

REV.	DESCRIPTION	SIGN	DATE
A	NEW	Fred.Tong	17/06/15

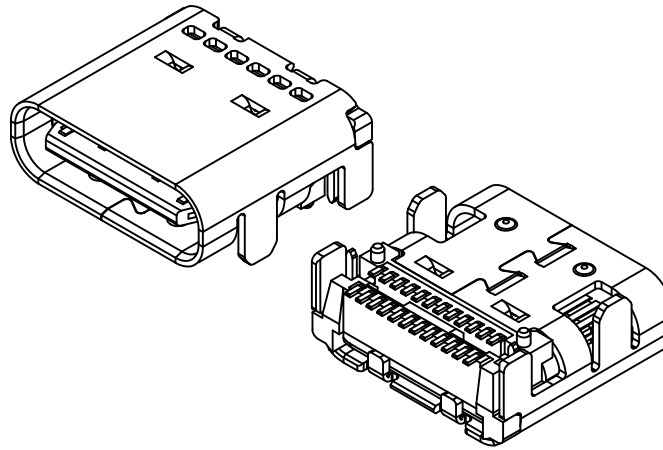

- ELECTRICAL: 0.25A MIN FOR OTHER.
VOLTAGE: 5VAC MAX
WITHSTANDING VOLTAGE: 100V AC.
CONTACT RESISTANCE: 40mΩ MAX.
INSULATION RESISTANCE: 100MΩ MIN.
- MECHANICAL:
INSERTION: 5~20N.
EXTRACTION: 8~20N.
DURABILITY: 10000 CYCLES
- ENVIRONMENTAL
TEMPERATURE RANGE -55°C ~ +85°C

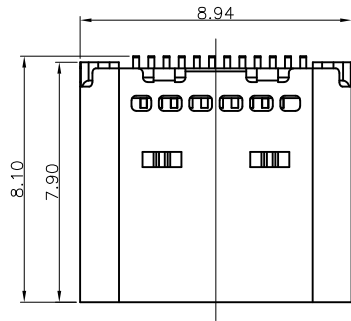
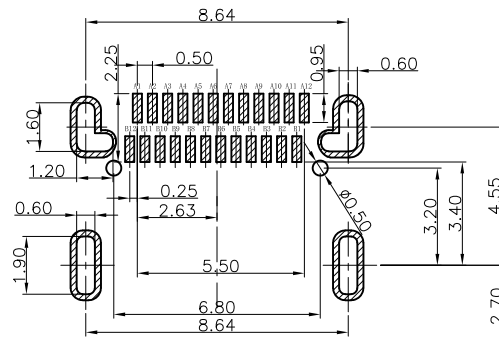
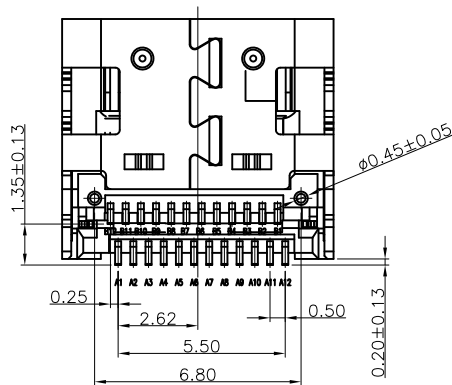
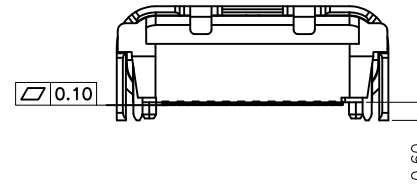
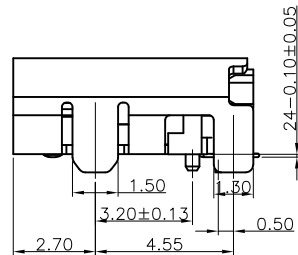
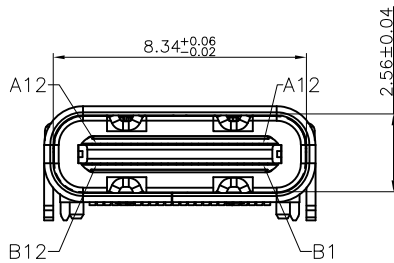

RECOMMENDED P.C.B LAYOUT
TOLERANCE UNSPECIFIED ±0.05mm

4.MATERIAL LIST:

No.	PART NAME	QTY	MATERIAL	REMARK
4	MID PLATE	1	STAINLESS STEEL	NI PLATED
3	SHELL	1	STAINLESS STEEL	NI PLATED
2	CONTACT	24	COPPER ALLOY	GOLD PLATED
1	HOUSING	1	THERMOPLASTIC(LCP)	(UL 94V-0)

GENERAL TOLERANCES (UNLESS SPECIFIED)		DRAWN BY	DATE
ITEM	MM	Alen.Yu	17/06/15
3 PLACE	±0.15	CHECKED BY	DATE
2 PLACE	±0.25	Fred.Tong	17/06/15
1 PLACE	±0.35	APPROVED BY	DATE
0 PLACE	±0.50		

EDOM ELECTRONICS TEL: +86 0755 27801940
Mob: +86 15889397634
www.techedom.com

TITLE:
USB3.1 C TYPE FEMALE R/A SMT
板上型 带定位柱 无LOGO

ANGULAR ± 3°			SIZE	PART NO.
METRIC	U.S.		A4	EU24MB3N11253
MM	INCHES	SCALE	N/A	SHEET 1 OF 1

THIS DRAWING CONTAINS INFORMATION THAT IS PROPRIETARY TO EDOM INCORPORATED AND SHOULD NOT BE USE WITHOUT WRITTEN PERMISSION

REV.
A