

RoHS Compliant

REV.	DESCRIPTION	SIGN	DATE
A	NEW	Fred.Tong	17/06/20

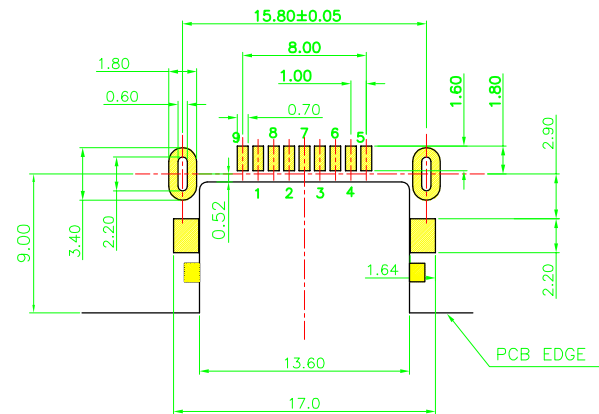
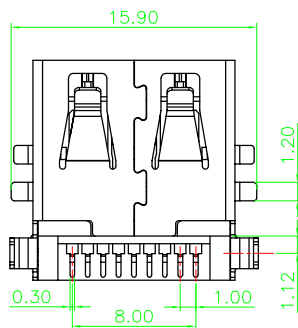
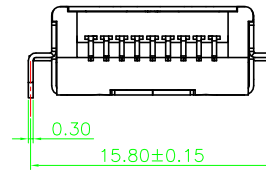
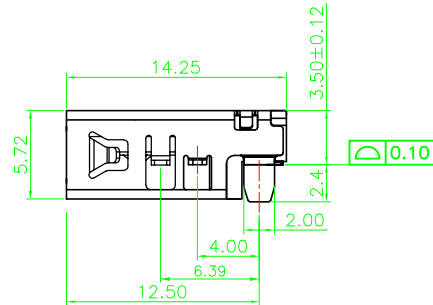
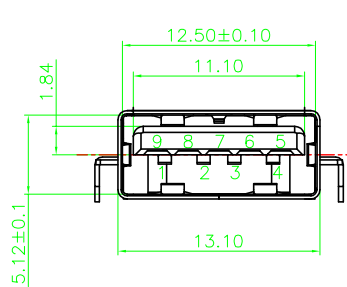
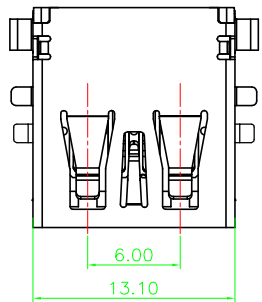

RECOMMENDED PCB LAYOUT

NOTES:

- ELECTRONIC:
 - CONTACT CURRENT RATING:1.5A
 - CONTACT RESISTANCE: 30mohm MAX
 - INSULATION RESISTANCE: 1000 Mohm MIN
 - WITHSTAND VOLTAGE:AC 500V,1min.
- MECHANICAL:
 - MATING FORCE:3.50KG MAX
 - UNMATED FORCE:0.8KG MIN.
- ENVIRONMENT CHARACTERISTICS:
 - OPERTING TEMPERATURE:-55°C TO +105°C

4.MATERIAL LIST:

No.	PART NAME	QTY	MATERIAL	REMARK
3	SHELL	1	COPPER ALLOY	NI PLATED
2	CONTACT	9	COPPER ALLOY	AU /TIN PLATED
1	HOUSING	1	THERMOPLASTIC(LCP)	(UL 94V-0) BLUE

GENERAL TOLERANCES (UNLESS SPECIFIED)			DRAWN BY	DATE
ITEM	MM	INCH	Alen.Yu	19/01/01
3 PLACE	±0.15	±0.005	CHECKED BY	DATE
2 PLACE	±0.25	±0.01	Liang.Li	19/01/06
1 PLACE	±0.35	±0.015	APPROVED BY	DATE
0 PLACE	±0.50	±0.02	Fred.Tong	19/01/06

EDOM ELECTRONICS TEL: +86 0755 27801940
 Mob: +86 15889397634
 www.techedom.com

TITLE:
 USB 3.0 AF R&A 沉板H=3.5 SMT
 外壳6支脚 直脚 无卷边

ANGULAR ± 3°		ANGLE OF PROJECTION	SIZE	PART NO.
METRIC	U.S.		A4	EU09FL1N11227
MM	INCHES		SCALE	N/A

THIS DRAWING CONTAINS INFORMATION THAT IS PROPRIETARY TO EDOM INCORPORATED AND SHOULD NOT BE USE WITHOUT WRITTEN PERMISSION

REV. B