

RoHS Compliant

REV.	DESCRIPTION	SIGN	DATE
A	NEW	Fred.Tong	2018/12/27

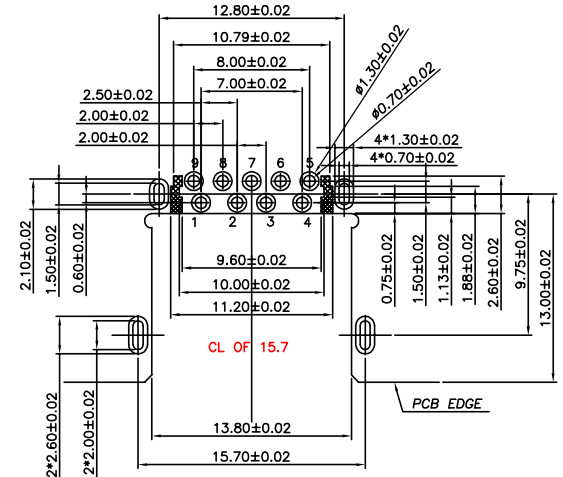
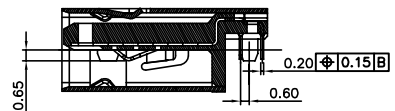
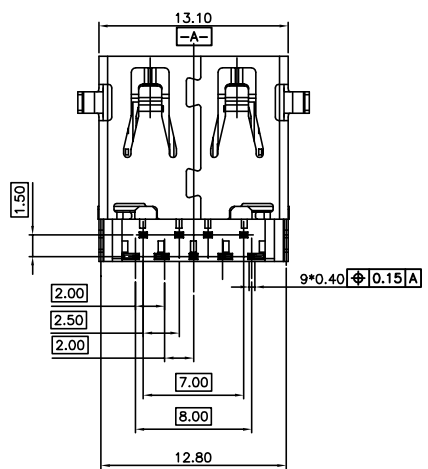
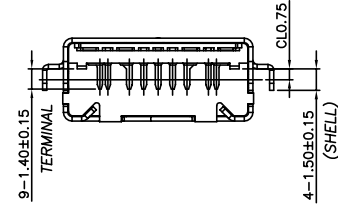
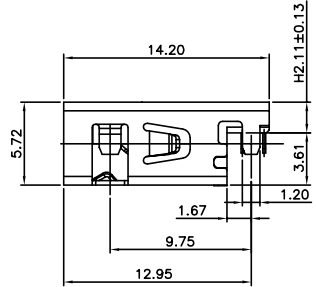
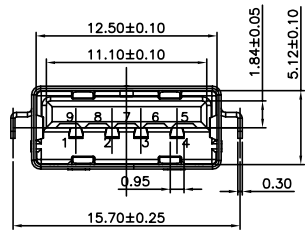
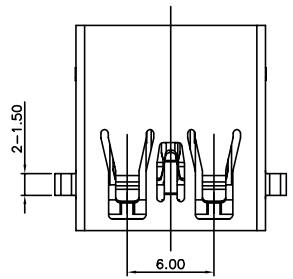

RECOMMENDED PCB LAYOUT

NOTES:

- 1.ELECTRONIC:
CONTACT RESISTANCE: 30mohm MAX
INSULATION RESISTANCE: 1000 Mohm MIN
WITHSTAND VOLTAGE:AC 500V,1min.
- 2.MECHANICAL:
DURABILITY: 5000 CYCLE.
- 3.ENVIRONMENT CHARACTERISTICS:
OPERTING TEMPERATURE:-55°C TO +105°C
- 4.RECOMMANDER PCB THICKNESS 1.2 TO 1.60MM
- 5.MATERIAL LIST:

3	SHELL	1	STAINLESS	NI PLATED
2	CONTACT	9	COPPER ALLOY	AU/TIN PLATED
1	HOUSING	1	PA9T BLUE	(UL 94V-0)

No.	PART NAME	QTY	MATERIAL	REMARK
GENERAL TOLERANCES (UNLESS SPECIFIED)		DRAWN BY Alen.Yu		DATE 2018/12/27
ITEM	MM	INCH	CHECKED BY Fred.Tong	DATE 2018/12/27
3 PLACE	±0.15	±0.005	APPROVED BY DATE	
2 PLACE	±0.25	±0.01	ANGLE OF PROJECTION	
1 PLACE	±0.35	±0.015	SIZE A4	
0 PLACE	±0.50	±0.02	PART NO. EU09FL3N11214	
ANGULAR ± 3°		METRIC U.S.		SCALE N/A
MM INCHES		SHEET 1 OF 1		

EDOM ELECTRONICS TEL: +86 0755 27801940
Mob: +86 15889397634
www.techedom.com

TITLE: USB 3.0 AF R&A DIP L14.20 H2.11
无卷边

THIS DRAWING CONTAINS INFORMATION THAT IS PROPRIETARY TO EDOM INCORPORATED AND SHOULD NOT BE USE WITHOUT WRITTEN PERMISSION

REV. A